



EASTWOOD ANDREWS



29 Paramount Crescent St Albans Park VIC

5 2 2

Situated in this family friendly and highly sought after suburb, 10 minutes to Geelong CBD and minutes from local shops, schools and sporting reserves, this home is sure to appeal to a family looking for plenty of living space in a convenient location.

Comprising formal lounge plus an open plan kitchen/dining/family area. The timber kitchen provides gas cooktop, electric oven, dishwasher and plenty of storage space. The five bedrooms are all a good size, the master is at the front of the home with WIR and ensuite, the remaining 4 bedrooms are zoned towards the back of the home and each have built in robes. The family bathroom provides a separate bath and shower, separate toilet.

Opening through glass sliding doors from the dining room is an expansive decked area with cafe blinds, allowing use all year round. The double garage is remote controlled plus there are side gates allowing access to the back yard.

Price : \$ 550,000
Land Size : 669 sqm
View : <https://www.eastwoodandrews.com.au/sale/vic/geelong-district/st-albans-park/residential/house/5927784>



Nicole Andrews
03 5201 0575



Andrew Crowhurst
03 5201 0575

<https://www.eastwoodandrews.com.au>



Whilst bwrn.com.au has made every attempt to ensure the accuracy of the floor plan contained here, measurements are approximate and no responsibility is taken for any error, omission, or mis-statement. This plan is for illustrative purposes only.

29 Paramount Crescent, St Albans Park

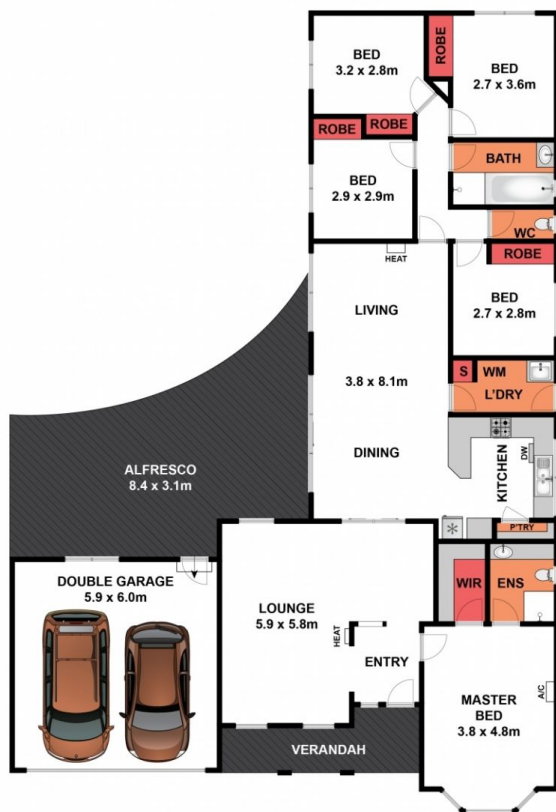

SITE PLAN

Whilst bwrn.com.au has made every attempt to ensure the accuracy of the floor plan contained here, measurements are approximate and no responsibility is taken for any error, omission, or mis-statement. This plan is for illustrative purposes only.

29 Paramount Crescent, St Albans Park