



EASTWOOD ANDREWS



**11 Birkenhead Drive Grovedale VIC**

4 2 1

Set in the heart of Grovedale, close to Mandama Primary, Torquay Rd and Waurn Ponds Shopping centre, you'll love the convenience of this sought after location. The versatile layout offers great separation of living zones & bedrooms that creates a brilliant family package. Upon entry the original 3 bedrooms all have robes, through to a spacious lounge (with French doors allowing separation) and the family bathroom includes a corner spa. The kitchen is the central hub with excellent storage and bench space, new dishwasher and overlooks the back yard, ideal for keeping an eye on the kids. The home opens up to a generous dining/ family living zone with stacker doors spilling out on to the large north facing deck, ideal for indoor/outdoor living & entertaining. The master suite at the rear offers privacy with generous WIR and Ensuite. The updated laundry has excellent storage and the over size single garage features a workshop/office area and direct internal access. The neat

**Price** : \$ 681,000  
**Land Size** : 599 sqm  
**View** : <https://www.eastwoodandrews.com.au/sale/vic/geelong-district/grovedale/residential/home/6497359>



**Andrew Crowhurst**  
03 5201 0575

<https://www.eastwoodandrews.com.au>



Whilst [bwrn.com.au](http://bwrn.com.au) has made every attempt to ensure the accuracy of the floor plan contained here, measurements are approximate and no responsibility is taken for any error, omission, or mis-statement. This plan is for illustrative purposes only.

## 11 Birkenhead Drive, Grovedale



GROUND FLOOR

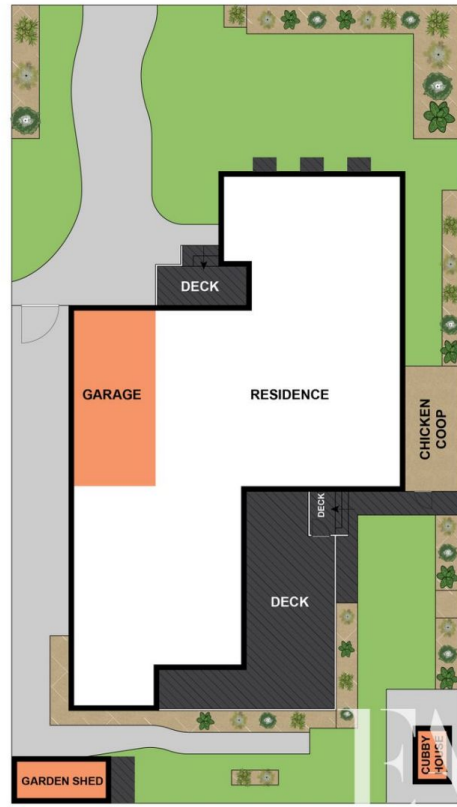

SITE PLAN

Whilst [bwr.com.au](http://bwr.com.au) has made every attempt to ensure the accuracy of the floor plan contained here, measurements are approximate and no responsibility is taken for any error, omission, or mis-statement. This plan is for illustrative purposes only.

## 11 Birkenhead Drive, Grovedale