



EASTWOOD ANDREWS



10 Robin Avenue Norlane VIC

2 1 2

Put this one at the top of your list for value for money and a smart buy. Located in a rapidly changing area with rebuilds and developments rejuvenating this popular suburb. Located less than 10 minutes to CBD, Waterfront and Ring Road, the area is popular with first home buyers, investors and downsizers.

What a stunning renovation! With fresh interiors including spacious lounge with split system heating/cooling, updated kitchen with induction cooktop, electric oven & dishwasher. 2 large bedrooms with robes (WIR bed 2) and the stylish bathroom has a walk in shower & large vanity. The laundry is fully fitted with great storage and there's a raised washing machine space for easy access. The décor is on trend and the polished Baltic timber flooring creates a light bright feel. There's a great outdoor space with covered carport/alfresco area (with room for 2 cars), 3m x 3m shed with power and landscaped front yard adding to the appeal.

Price : \$ 378,000
Land Size : 276 sqm
View : <https://www.eastwoodandrews.com.au/sale/vic/geelong-district/norlane/residential/house/6502442>



Andrew Crowhurst
03 5201 0575



Sarabjeet Singh
5201 0575

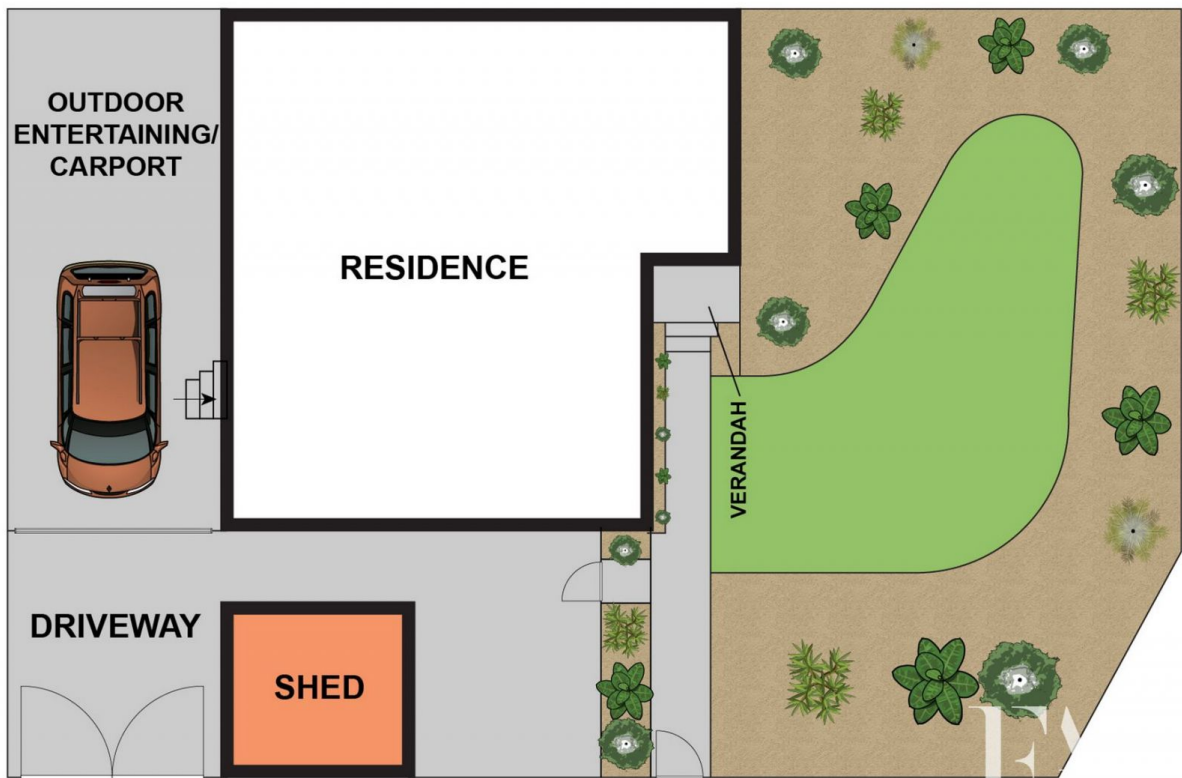

SITE PLAN

Whilst bwrn.com.au has made every attempt to ensure the accuracy of the floor plan contained here, measurements are approximate and no responsibility is taken for any error, omission, or mis-statement. This plan is for illustrative purposes only.

10 Robin Avenue, Norlane

EA
EASTWOOD ANDREWS

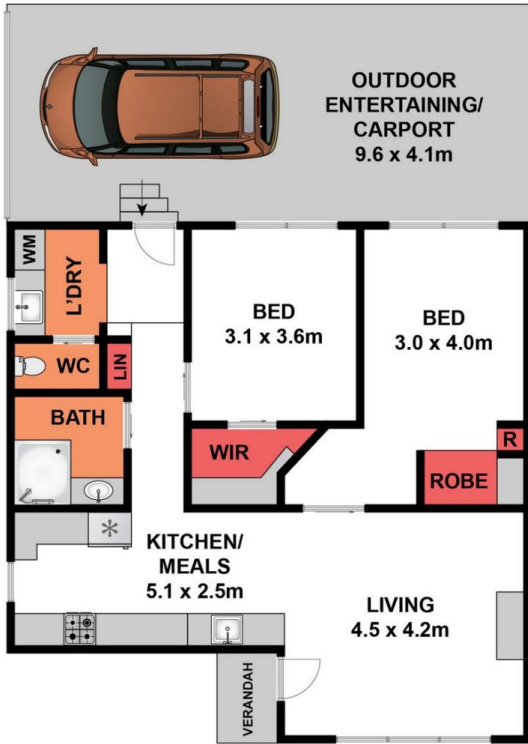

GROUND FLOOR



(NOT IN POSITION)

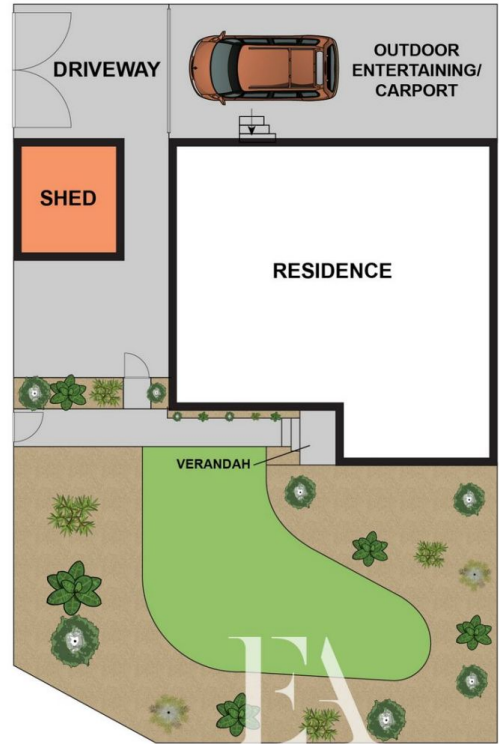

SITE PLAN

Whilst bwrn.com.au has made every attempt to ensure the accuracy of the floor plan contained here, measurements are approximate and no responsibility is taken for any error, omission, or mis-statement. This plan is for illustrative purposes only.

10 Robin Avenue, Norlane