



EASTWOOD ANDREWS



### 28 Colmar Street Lara VIC

4 2 2

Perfectly positioned in a Coridale Estate, this brand new custom built contemporary home is sure to satisfy all aspects of functionality, appeal and size.

With a spectacular fusion of class and presentation, the wide entrance is instantly welcoming, leading you through to the formal lounge and master bedroom, featuring spacious WIR and ensuite. The remaining 3 bedrooms has BIRs and zoned in the rear with an extra living space. This area is serviced by centralized bathroom with separate bath and shower and a separate toilet.

The intelligently designed free flowing open plan living is drenched with natural light making interiors an ideal spot to relax. The contemporary kitchen includes upgraded cabinetry, stone bench tops, 900mm upright cooker, overhead cupboards, dishwasher, feature pendant lights,

**Price** : \$ 715,000  
**Land Size** : 378 sqm  
**View** : <https://www.eastwoodandrews.com.au/sale/vic/geelong-district/lara/residential/house/6965978>



**Sarabjeet Singh**  
5201 0575



**Nicole Andrews**  
03 5201 0575

<https://www.eastwoodandrews.com.au>

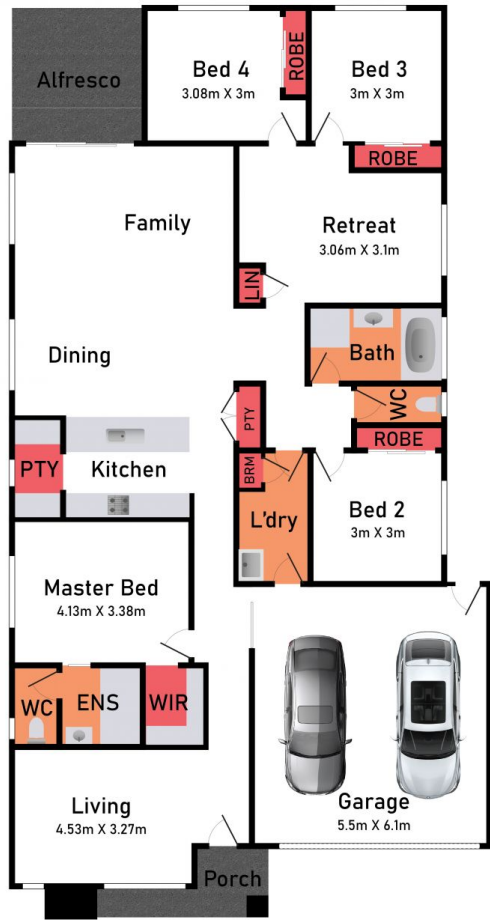

FLOOR PLAN

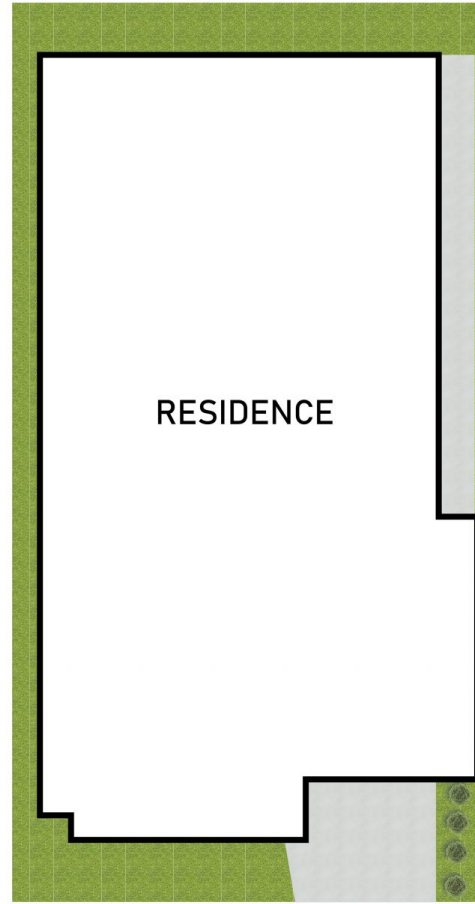

SITE PLAN

Preview Media has made every attempt to ensure the accuracy of the floor plan contained here, measurements are approximate and no responsibility is taken for any error, omission or misstatement. This plan is for illustrative purposes only.

28 COLMAR STREET, LARA