



EASTWOOD ANDREWS



14 Sovereign Drive Mount Duneed VIC

4 2 2

Nestled on an allotment of approximately 558sqm in a suburb oozing warm community lifestyle, this beautiful family home is only moments to local shops, eateries and public transport. Freshly painted throughout, this home enjoys abundant natural light and a layout designed for easy living, comfort and entertaining.

Price : \$830,000-\$890,000
Land Size : 558 sqm
View : <https://www.eastwoodandrews.com.au/sale/vic/geelong-district/mount-duneed/residential/house/6986833>

Upon Entrance, your are greeted by an impressive hallway, the front door opens to opulent master bedroom with his/hers WIR's and an Ensuite featuring dual vanity and a shower. The clever layout zones the remaining 3 bedroom and a family bathroom & a separate toilet from the main, ensuring peace and privacy for all family members.

The sleek and stylish kitchen showcases 900mm upright cooker, stone benchtop, dishwasher, equipped with ample storage and walk in pantry.



Sarabjeet Singh
5201 0575



Nicole Andrews
03 5201 0575

<https://www.eastwoodandrews.com.au>

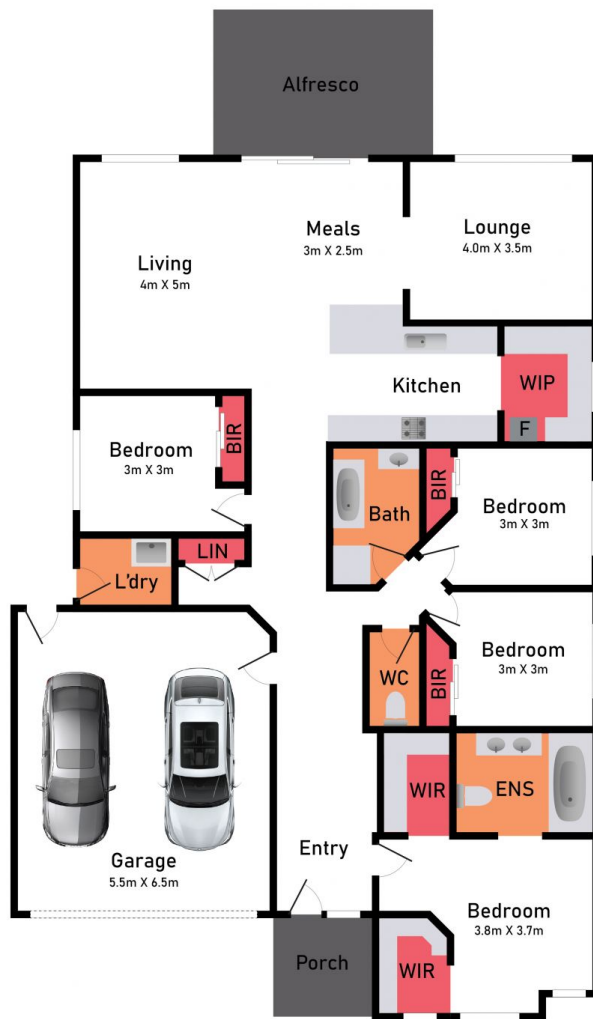

FLOOR PLAN

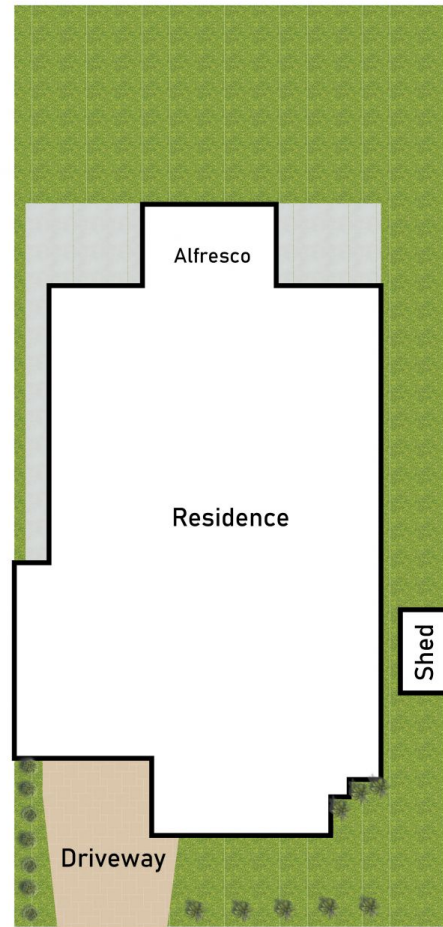

SITE PLAN

Preview Media has made every attempt to ensure the accuracy of the floor plan contained here, measurements are approximate and no responsibility is taken for any error, omission or misstatement. This plan is for illustrative purposes only.

14 SOVEREIGN DRIVE, MOUNT DUNEED