



EASTWOOD ANDREWS



5 Newhaven Avenue St Albans Park VIC

3 2 2

Priced to sell, with committed vendors wanting to see a sold sticker on the board, you won't want to miss this one. With stunning street appeal and gardens to be proud of, this immaculate 2006 built home is in a class of its own.

Situated on a corner allotment with north facing living and entertaining areas, your search is sure to be over. Offering a spacious and versatile floorplan with plenty of natural light throughout plus a private and low maintenance courtyard, making it the perfect choice for downsizers, first home buyers and investors.

Features:

- Light filled open plan kitchen/dining/living
- Kitchen with stainless steel gas cooktop, electric fan forced oven, dishwasher, large pantry and plenty of cupboard space
- Three large bedrooms each with built in robes
- Large master bedroom with ensuite

Land Size : 375 sqm

View : <https://www.eastwoodandrews.com.au/sale/vic/geelong-district/st-albans-park/residential/townhouse/7183949>



Nicole Andrews
03 5201 0575



Stephen Thomas
03 5201 0575

<https://www.eastwoodandrews.com.au>

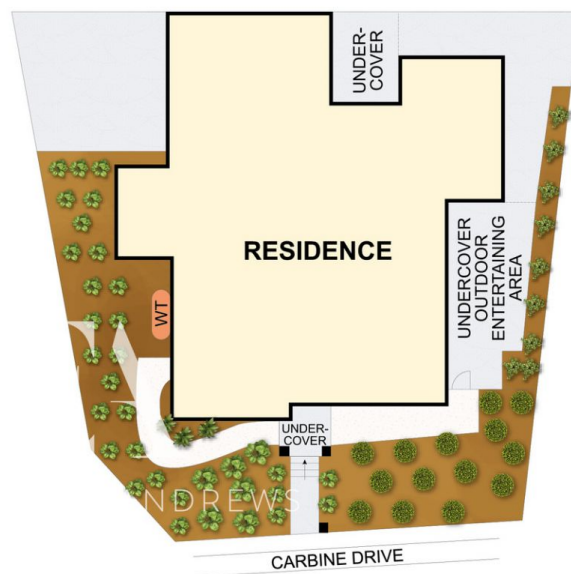

THE ABOVE PLAN IS AN ARTIST'S IMPRESSION ONLY, IT INCLUDES ELEMENTS THAT ARE FOR DISPLAY PURPOSES ONLY AND MAY NOT BE TO SCALE. LANDSCAPING SHOWN IS INDICATIVE ONLY. DIMENSIONS ARE APPROXIMATE.