



EASTWOOD ANDREWS



### 125 Goldsworthy Road Corio VIC

3 2 2

Situated in Corio's best pocket and set on 688m<sup>2</sup>, this spacious family home is sure to impress. Upon entry there's a formal lounge and master bedroom, Ensuite with WIR, The fantastic U Shaped kitchen is the hub of the home with breakfast bar, great storage, SS cooktop & oven with separate fridge space, pantry and outlooking dining area. Spacious Central living/family area is a great spot to gather with family & friends. The 2 rear bedrooms are zoned off with their own family bathroom and separate toilet. Separate laundry with outdoor access completes this family home.

Outdoor entertaining is a breeze with a large alfresco area 5.5M X 6M and the double garage.

Additional features include:

- 5.5KW Solar panels.
- Remote control window shutters.
- Ducted heating throughout.

**Price** : \$ 600,000  
**Land Size** : 688 sqm  
**View** : <https://www.eastwoodandrews.com.au/sale/vic/geelong-district/corio/residential/house/7287316>



**Sarabjeet Singh**  
5201 0575



**Nicole Andrews**  
03 5201 0575

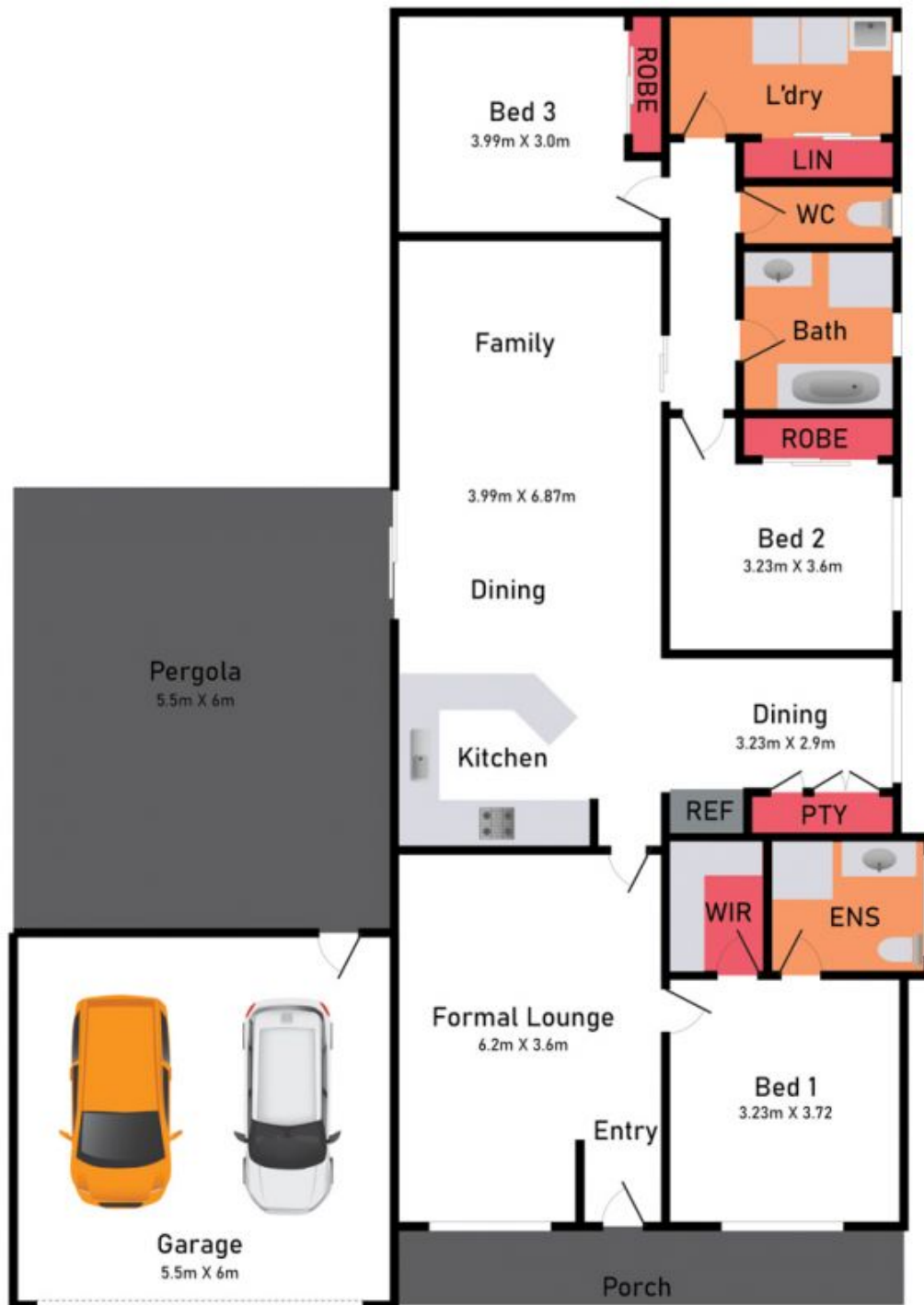

## FLOOR PLAN

Preview Media has made every attempt to ensure the accuracy of the floor plan contained here, measurements are approximate and no responsibility is taken for any error, omission or misstatement. This plan is for illustrative purposes only.

125 GOLDSWORTHY ROAD, CORIO



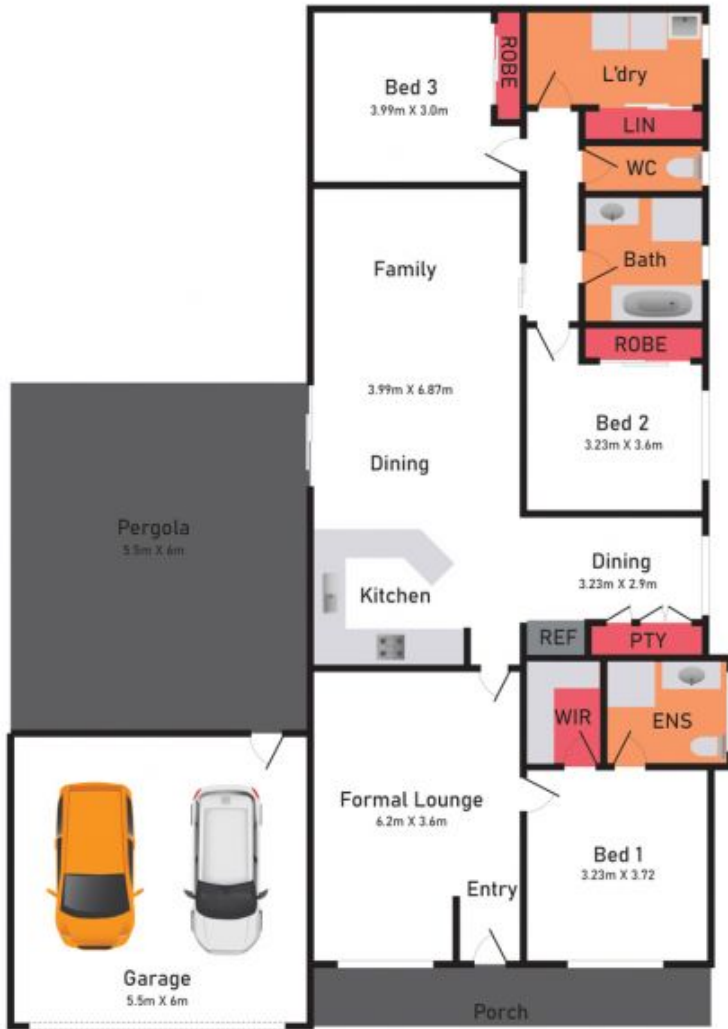

FLOOR PLAN

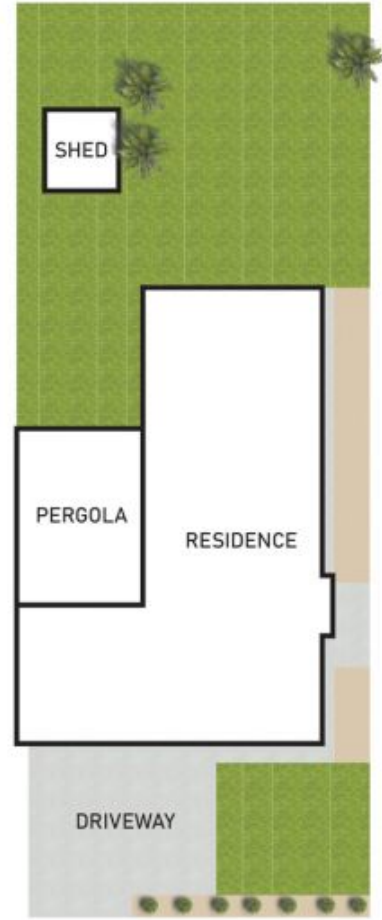

SITE PLAN

Preview Media has made every attempt to ensure the accuracy of the floor plan contained here, measurements are approximate and no responsibility is taken for any error, omission or misstatement. This plan is for illustrative purposes only.

125 GOLDSWORTHY ROAD, CORIO

