



EASTWOOD ANDREWS



5 Carbine Drive St Albans Park VIC

3 2 4

Situated only 15 minutes to Geelong CBD and the Bellarine, minutes to local schools, shopping centres and sporting reserves, this home is perfect for a first home buyer or investor, with a potential rental income of \$460 per week

Price : \$ 592,000
Land Size : 577 sqm
View : <https://www.eastwoodandrews.com.au/sale/vic/geelong-district/st-albans-park/residential/house/7321635>

Features:

- Large lounge with wood heater and reverse cycle air conditioner
- Kitchen/dining opening through sliding doors to the outdoor entertaining space
- Well appointed kitchen with ample cupboard space and gas stove
- 3 bedrooms, master with ensuite and walk in robe, remaining two have BIRs



Nicole Andrews
03 5201 0575



Sarabjeet Singh
5201 0575

<https://www.eastwoodandrews.com.au>

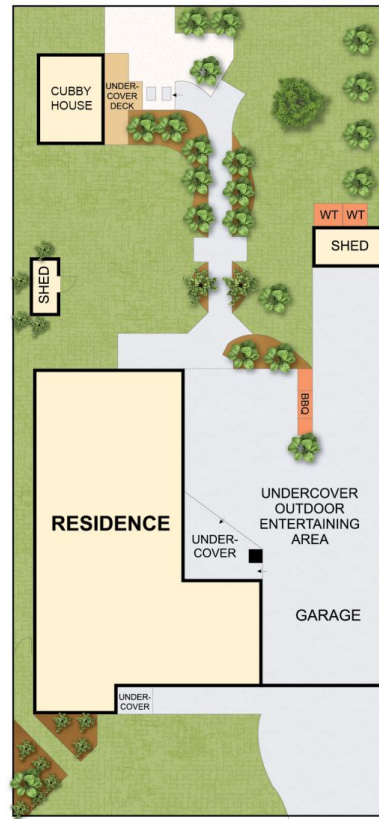
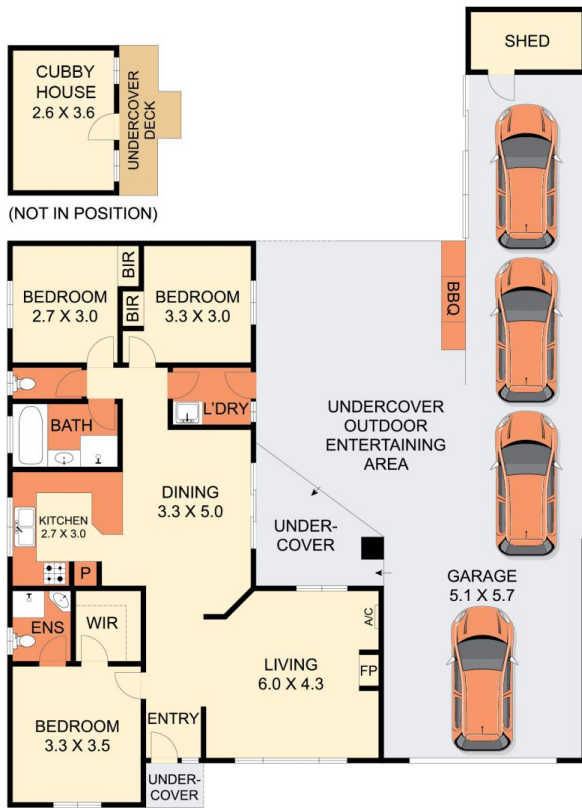

THE ABOVE PLAN IS AN ARTIST'S IMPRESSION ONLY. IT INCLUDES ELEMENTS THAT ARE FOR DISPLAY PURPOSES ONLY AND MAY NOT BE TO SCALE. LANDSCAPING SHOWN IS INDICATIVE ONLY. DIMENSIONS ARE APPROXIMATE.