



EASTWOOD ANDREWS



1/38 Peter Street Grovedale VIC

3 1 2

Here's the perfect stand alone townhouse, set on 282m² of land, it has been freshly painted, updated and it presents beautifully. The open plan living has abundant natural light with the dining area opening to the north facing patio area. The neat U-Shaped kitchen offers good work space, storage and a new oven. There's 3 double bedrooms with robes and the bathroom is light and bright with bath, shower recess and vanity, plus the separate toilet offers good functionality. The double remote garage has direct internal door access plus a rear personal access door to the rear yard. Perfectly located in the heart of Grovedale you'll be only minutes to Waurin Ponds shopping centre, Grovedale Hotel and big box retail shopping, good access to Deakin Uni via bus & the V-Line Marshall Station nearby.

Land Size : 282 sqm
View : <https://www.eastwoodandrews.com.au/sale/vic/geelong-district/grovedale/residential/house/7379715>



Andrew Crowhurst
03 5201 0575



Stephen Thomas
03 5201 0575

All information is provided by third parties. Prospective purchasers are advised to make their own enquiries with

<https://www.eastwoodandrews.com.au>

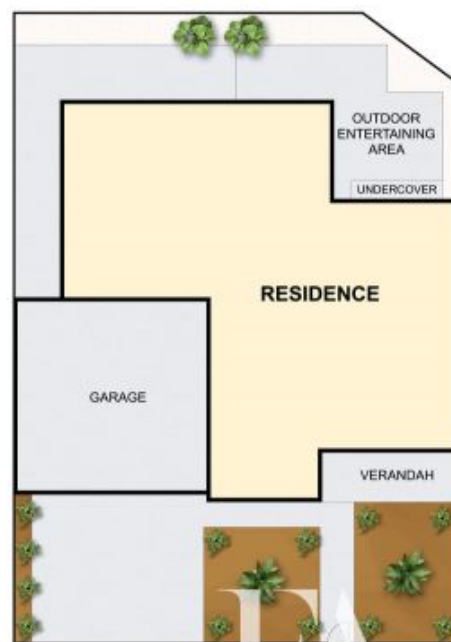

THE ABOVE PLAN IS AN ARTIST'S IMPRESSION ONLY. IT INCLUDES ELEMENTS THAT ARE FOR DISPLAY PURPOSES ONLY AND MAY NOT BE TO SCALE. LANDSCAPING SHOWN IS INDICATIVE ONLY. DIMENSIONS ARE APPROXIMATE.