



EASTWOOD ANDREWS



### 11 Birkenhead Drive Grovedale VIC

4 2 1

You'll love the convenience of this sought after location in the heart of Grovedale, close to Mandama Primary, Torquay Rd and Waurn Ponds Shopping centre.

With 2 living areas, 4 bedrooms (including Master with WIR and Ensuite). The versatile layout offers great separation of living zones and the central kitchen is the hub of the home with excellent storage and bench space, new dishwasher and overlooks the back yard, ideal for keeping an eye on the kids. The home opens up to a generous dining/ family living zone with stacker doors spilling out on to the large north facing deck, ideal for indoor/outdoor living & entertaining. The updated laundry has excellent storage and the remote over size single garage features a workshop/office area and direct internal access. The neat yard includes a garden shed, cubby house and is secure

**Type** : House  
**Price** : \$ 675,000  
**Land Size** : 599 sqm  
**View** : <https://www.eastwoodandrews.com.au/sale/vic/geelong-district/grovedale/residential/home/7689715>

[For full version visit the website](#)



**Andrew Crowhurst**  
03 5201 0575



**Stephen Thomas**  
03 5201 0575

<https://www.eastwoodandrews.com.au>



GROUND FLOOR

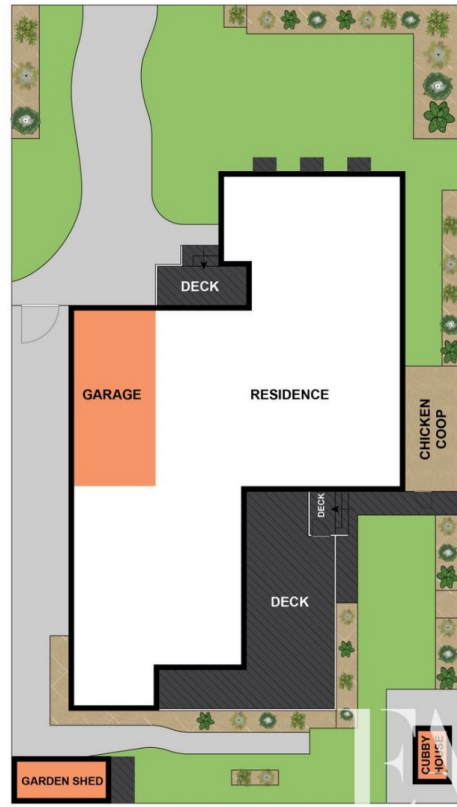

SITE PLAN

Whilst [bwr.com.au](http://bwr.com.au) has made every attempt to ensure the accuracy of the floor plan contained here, measurements are approximate and no responsibility is taken for any error, omission, or mis-statement. This plan is for illustrative purposes only.

# 11 Birkenhead Drive, Grovedale



GROUND FLOOR

Whilst [bwrn.com.au](http://bwrn.com.au) has made every attempt to ensure the accuracy of the floor plan contained here, measurements are approximate and no responsibility is taken for any error, omission, or mis-statement. This plan is for illustrative purposes only.

## 11 Birkenhead Drive, Grovedale