



EASTWOOD ANDREWS



10 Myrtle Avenue Newcomb VIC

3 2 2

Set on a generous 684m2 in Newcomb's most sought-after position only one street from blue chip East Geelong, this masterfully crafted family home seamlessly combines style, practicality, and luxurious comfort. Thoughtfully updated to retain its original character, this home creates a lifestyle that your whole family can enjoy. With an enviable outdoor entertaining area complete with a open fire, bar, remote blinds, and separate self-contained guest living, this is your chance to secure your dream home only 5 minutes from Geelong CBD and Waterfront. This classic weatherboard features ornate cornice, high ceilings, and polished timber floors, infused with modern comforts including beautiful gas log/ducted heating, split system heating and cooling for year-round comfort, ceiling fans and double block-out blinds throughout. The charming entryway flows through to the open plan living area revealing soaring ceilings with skylights creating a sense of light and space. The

Price : \$ 925,000
Land Size : 684 sqm
View : <https://www.eastwoodandrews.com.au/sale/vic/geelong-district/newcomb/residential/house/7814624>



Jayden Overall
03 5201 0575



Nicole Andrews
03 5201 0575



Whilst bwrn.com.au has made every attempt to ensure the accuracy of the floor plan contained here, measurements are approximate and no responsibility is taken for any error, omission, or mis-statement. This plan is for illustrative purposes only.

10 Myrtle Avenue, Newcomb



GROUND FLOOR

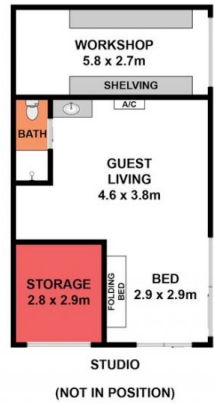

STUDIO
(NOT IN POSITION)



SITE PLAN

Whilst bwrn.com.au has made every attempt to ensure the accuracy of the floor plan contained here, measurements are approximate and no responsibility is taken for any error, omission, or mis-statement. This plan is for illustrative purposes only.

10 Myrtle Avenue, Newcomb

