



EASTWOOD ANDREWS



94 Sladen Street Hamlyn Heights VIC

3 1 3

Rest assured this home was built to last and is immaculate for its age. The 1970's was a time of change for home design as families grew and the need for space was a premium. This home is a classic for the area, open plan living with lounge and family living or work from home space, funky green kitchen with stainless steel cooker and the north facing dining space flows out to the covered rear patio. There's 3 bedrooms with built in robes, family bathroom with shower, bath and vanity. The alfresco patio area overlooks the neat back yard with established gardens and connects to the brick garage with workshops at rear. The double carport offers drive through access to the rear garage, ideal for tradies or for a boat or van. 602m² allotment.

All this located in one of Geelong's highest growth suburbs, with easy Ring Road access to Melbourne, close to schools, parkland, rail trail and Bus Route #25 offering

Land Size : 602 sqm

View : <https://www.eastwoodandrews.com.au/sale/vic/geelong-district/hamlyn-heights/residential/house/7843138>



Andrew Crowhurst
03 5201 0575



Jayden Overall
03 5201 0575

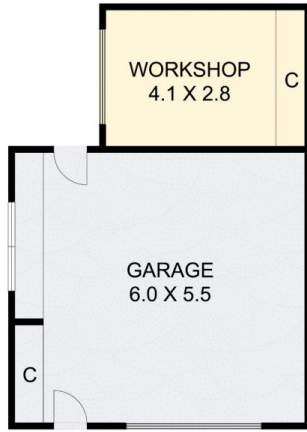

(NOT IN POSITION)

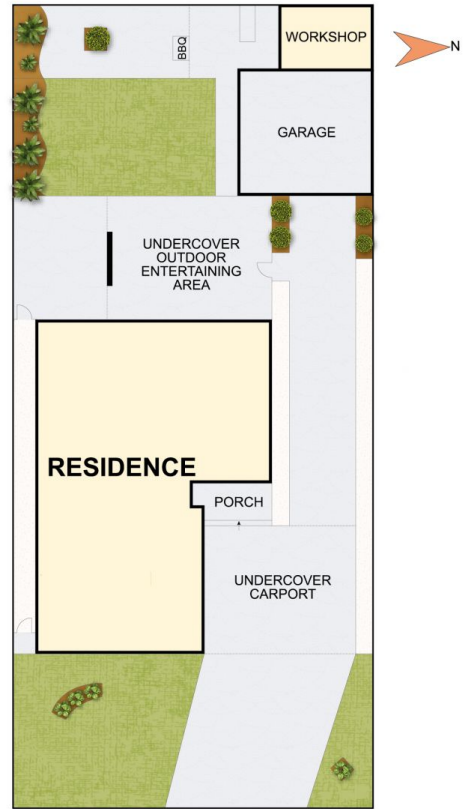

THE ABOVE PLAN IS AN ARTIST'S IMPRESSION ONLY. IT INCLUDES ELEMENTS THAT ARE FOR DISPLAY PURPOSES ONLY AND MAY NOT BE TO SCALE.
LANDSCAPING SHOWN IS INDICATIVE ONLY. DIMENSIONS ARE APPROXIMATE.