



EASTWOOD ANDREWS



11 Citrinus Street Mount Duneed VIC

4 2 2

A contemporary architecture, located in a peaceful street boasts versatile living, convenience and accessibility, the perfect fit for a first home buyer, downsizer or an investor.

Features:

- Spacious open plan kitchen/dining/family which opens out to the low-maintenance backyard, providing an inviting atmosphere for family gatherings and entertaining guests.
- The stylish and well appointed kitchen has 40mm stone benchtops, gas cooktop, fan forced oven, dishwasher and breakfast bar for casual dining.
- Four spacious bedroom, each offering comfort and tranquility. The master suite is a retreat of its own, zoned at the front of the property and featuring a private ensuite for added convenience.
- The beautifully appointed family bathroom is situated with

Price : CONTACT AGENT

View : <https://www.eastwoodandrews.com.au/sale/vic/geelong-district/mount-duneed/residential/house/7967894>



Sarabjeet Singh
5201 0575



Nicole Andrews
03 5201 0575

<https://www.eastwoodandrews.com.au>

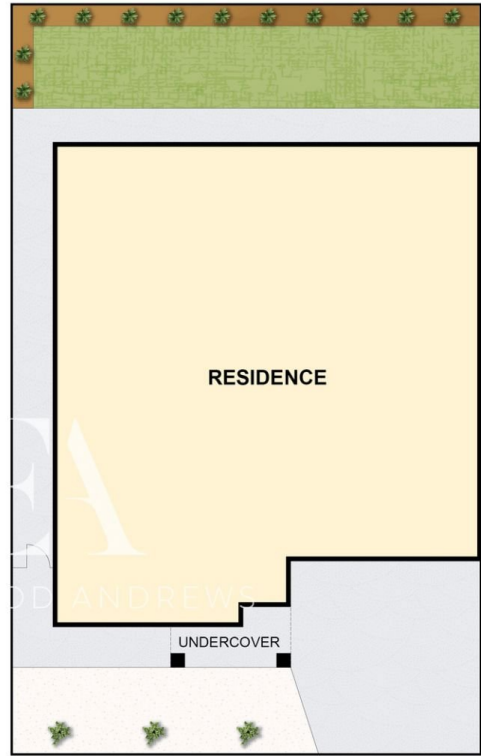
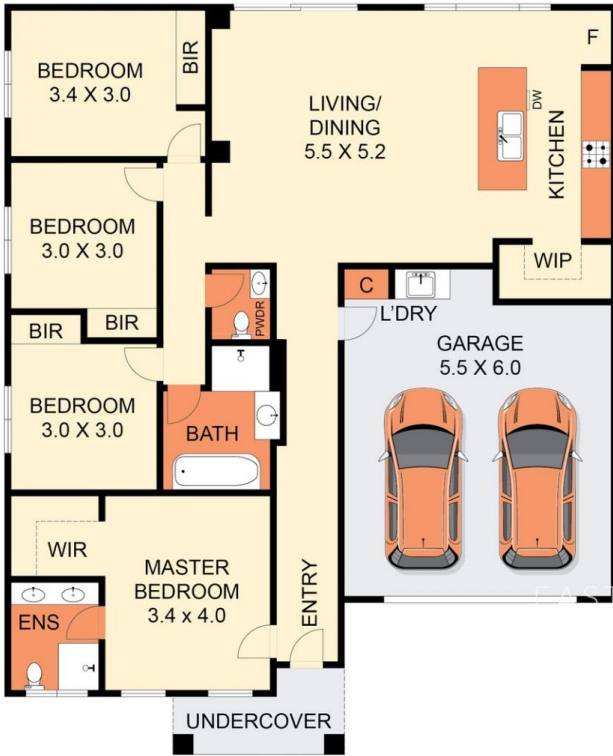

THE ABOVE PLAN IS AN ARTIST'S IMPRESSION ONLY. IT INCLUDES ELEMENTS THAT ARE FOR DISPLAY PURPOSES ONLY AND MAY NOT BE TO SCALE. LANDSCAPING SHOWN IS INDICATIVE ONLY. DIMENSIONS ARE APPROXIMATE.